

Approved	Checked	Designed	DEVELOPMENT SPECIFICATION							
<i>T. Okada</i>	<i>M. Hi</i>	<i>T. Takata</i>	TEMPORARY							
			P/N: LNJ218C8ARA1							
T	Y	P	E	Red Light Emitting Diode						
APPLICATION				Indicators						
MATERIAL				GaAlAs						
OUTLINE				Attached						
ABSOLUTE		P	※ I <sub>FP</sub>	I <sub>FDC</sub>	V <sub>R</sub>	Topr	Tstg			
MAXIMUM		60	100	20	3	-30~+85	-40~+100			
RATINGS		mW	mA	mA	V	°C	°C			
CONDITION				T <sub>a</sub> = 25 ± 3°C						
Test Specification										
Item	Symbol	Condition	Typ	Limit		Unit				
				Min	Max					
Forward Voltage	V <sub>F</sub>	I <sub>F</sub> = 10 mA	1.72		2.5	V				
Reverse Leakage Current	I <sub>R</sub>	V <sub>R</sub> = 3 V			100	μA				
Luminous Intensity	I <sub>O</sub>	I <sub>F</sub> = 10 mA · DC	14	7.4		mcd				
Peak Emission Wavelength	λ <sub>p</sub>	I <sub>F</sub> = 10 mA · DC	660			nm				
Spectral Line Half Width	Δλ	I <sub>F</sub> = 10 mA · DC	20			nm				
<p>※ · The Condition of I<sub>FP</sub> is duty 10 %, Pulse width 1 ms</p> <p>· Please contact the Panasonic local office if you design at low current (below 1 mA DC) or pulse current operation and have any questions.</p> <p>NOTE</p> <p>1. Soldering conditions. Refer to handling note.</p> <p>2. Care should be taken that soldering is done within 3-days after opening the dry package and reel.</p> <p>3. Compositions of the lead·····Cu/Ni/Au plating</p>										
Feb. 24. 2000										

Approved <i>T. Takata</i>	Checked <i>H. Ichi</i>	Designed <i>T. Takata</i>
------------------------------	---------------------------	------------------------------

DEVELOPMENT SPECIFICATION

P/N: LNJ218C8ARA1

TEMPORARY

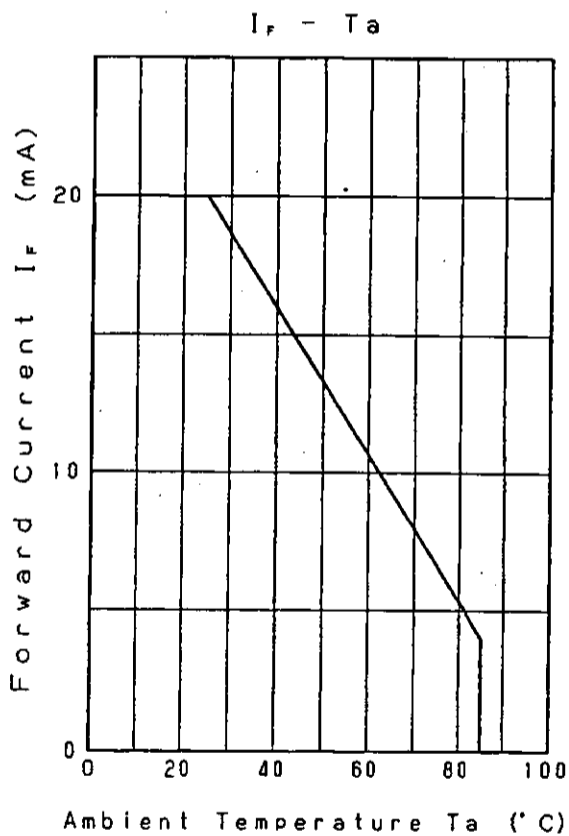
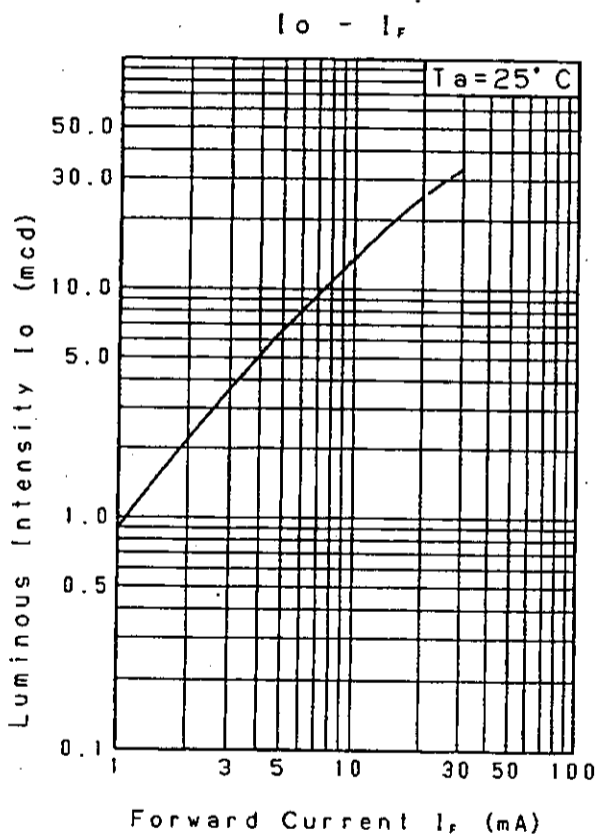
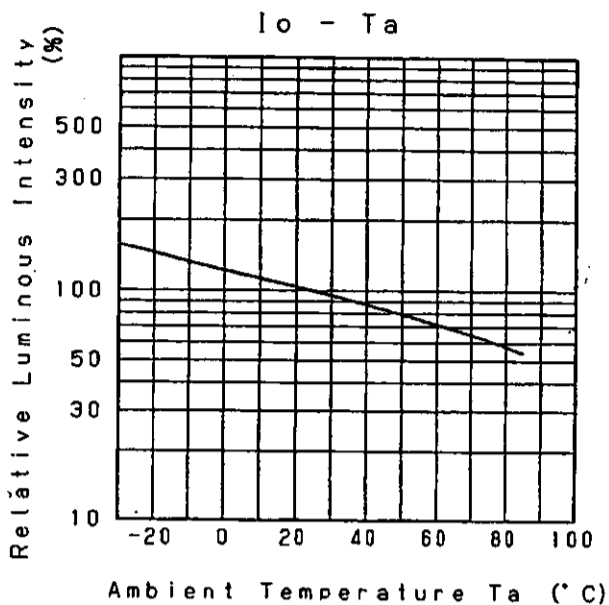
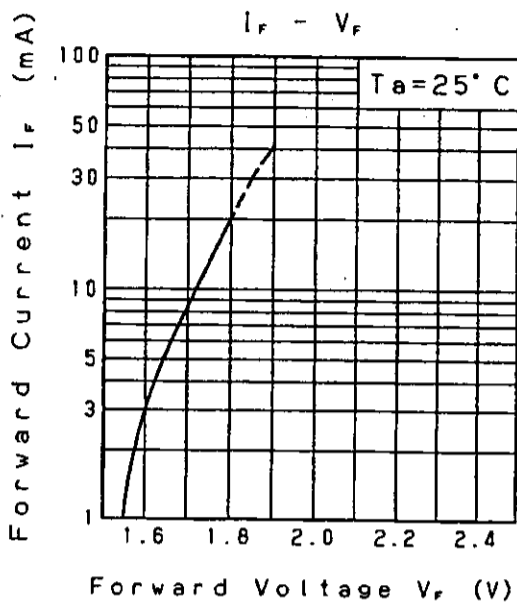

Feb. 24. 2000

Approved	Checked	Designed
<i>T. Tabata</i>	<i>M. Hi</i>	<i>T. Tabata</i>

DEVELOPMENT SPECIFICATION

P/N: LNJ218C8ARA1

TEMPORARY

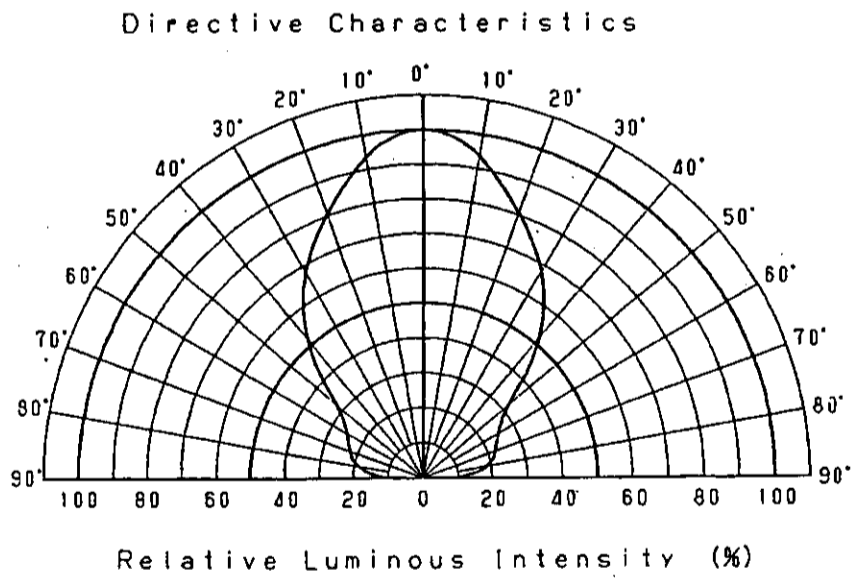
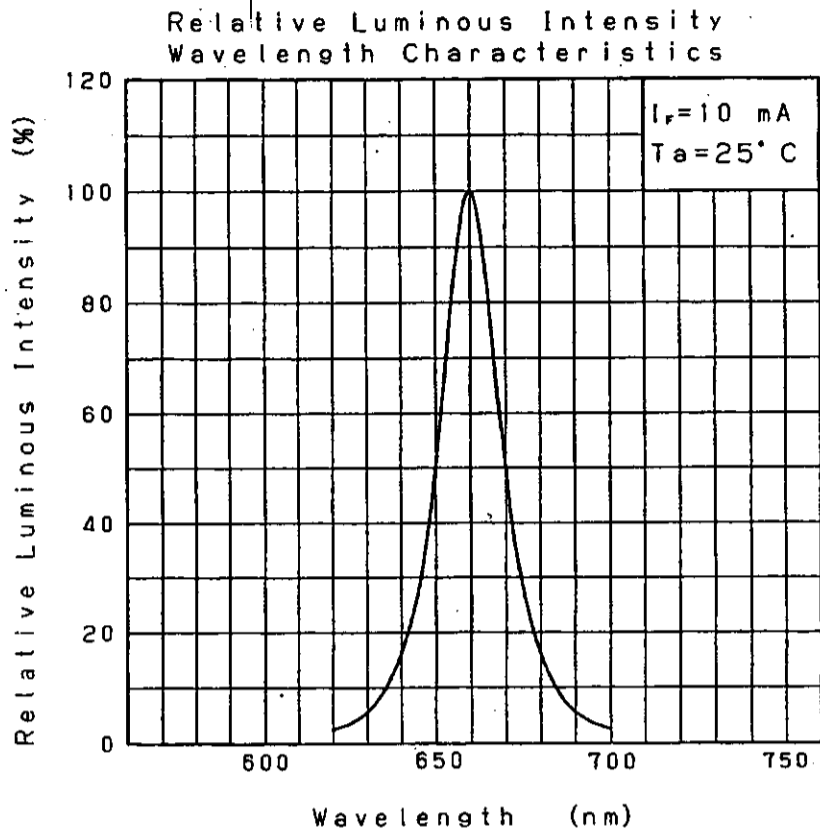

Feb. 24. 2000

Panasonic

KAGOSHIMA MATSUSHITA ELECTRONICS Co., Ltd.

KB-H-022-018B

Approved	Checked	Designed	DEVELOPMENT SPECIFICATION (OUTLINE) P/N: LNJ218C8ARA1
		T. Takahashi	

TEMPORARY

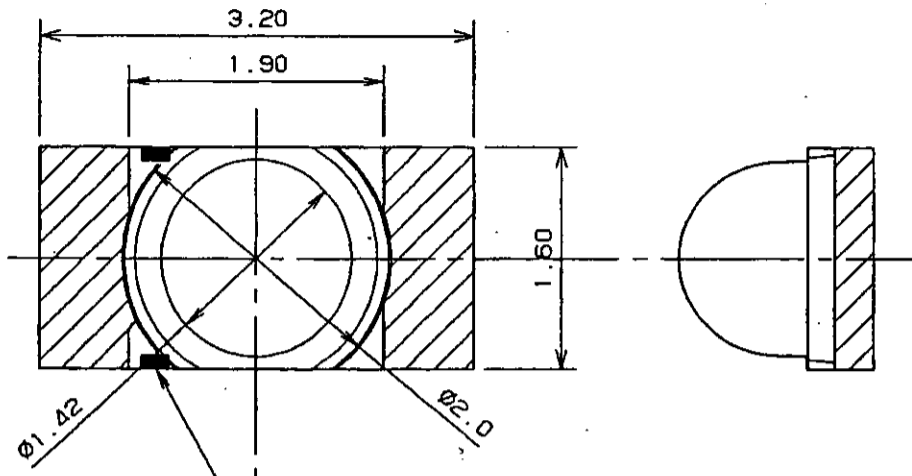

Polarity mark (Black)

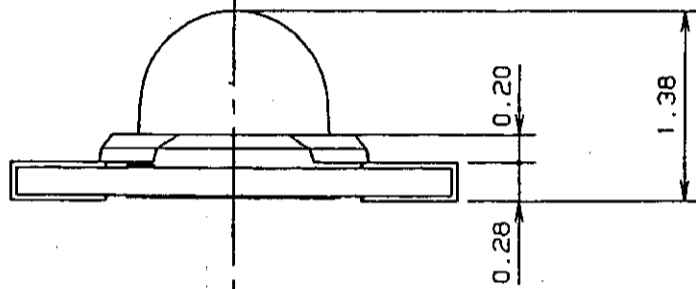

Polarity mark (Red)

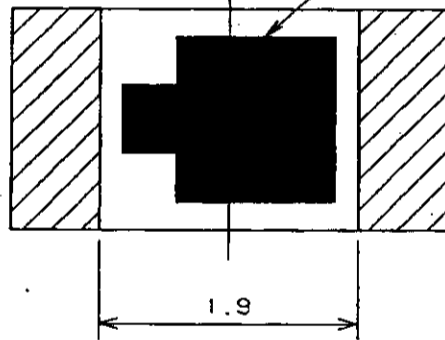

CATHODE

ANODE

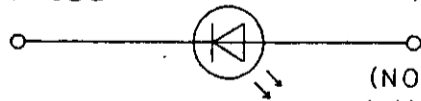

(NOTE)

1. Unit: mm

2. Tolerance unless specified is  $\pm 0.15$ .

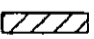
3.  indicate Au terminal.

Mar. 23. 2001